



ergonomic products

Performance Without Compromise™

INSTALLATION AND OPERATIONS MANUAL

C1D1: 30" Triple Resupply Pulldown

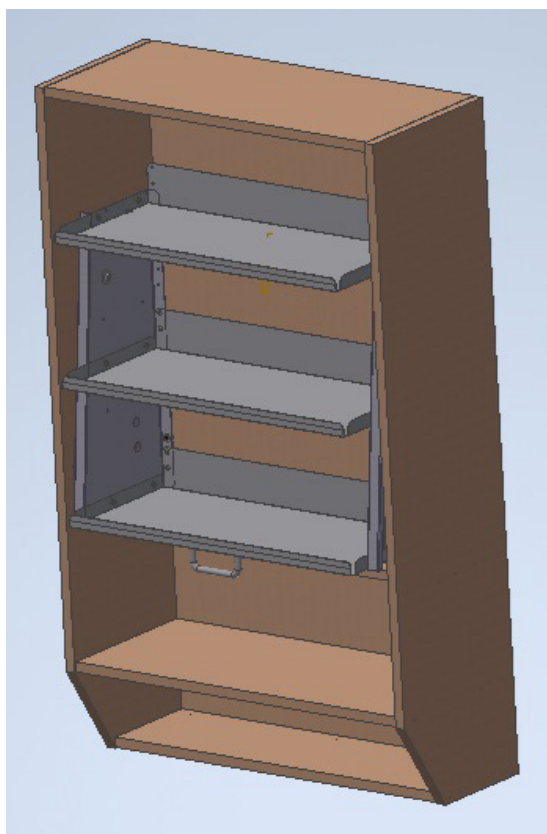



Thank you for purchasing the Ergonomic Products C1D1 30" Triple Resupply Pulldown.

Years of research by dentists, engineers, and designers have made this a uniquely effective product in the industry. We stand behind our equipment, and genuinely believe it to be the best available on the market.

Should you have any questions regarding the product's installation or use, please don't hesitate to call our customer service specialists at **1-866-ERGO-4-US**. We may also be reached via email at **equip@ergonomic-products.com**.

We hope that you enjoy the benefits and quality of your new equipment and look forward to assisting you with your future needs as your practice continues to grow!

—The Ergonomic Products Team

CONTENTS:

1. Required Tools / Unpacking and Inspecting.....	3
2. Specifications and Options.....	4
3. Framing.....	5
4. Installation.....	6
5. Installation for tilt bin *optional*	8

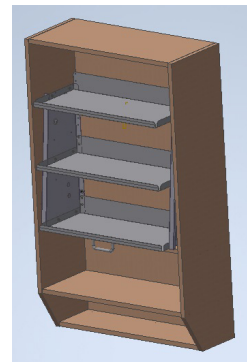

QUESTIONS?

Call our Customer Service Specialists at:
1-866-ERGO-4-US



1 – REQUIRED TOOLS / UNPACKING AND INSPECTING

REQUIRED TOOLS:

Long Phillips Head Screwdriver

Power Drill

Impact Driver

Construction Level

#8 2-1/2" wood screws for wood blocking. (not included)

#8 2-1/2" flat head self drill screws for sheet metal blocking *optional* (not included)

1. Inspect shipping container for visible damage upon arrival. If transit damage is found, contact Ergonomic Products immediately (this will expedite the corrective process).
2. Use safe lifting procedures to free the product from the container, and remove all packing material and accessory boxes from shipping container.
3. Lay individual components on clean surface to avoid scratching, and inspect contents. If damage is found, contact Ergonomic Products immediately.

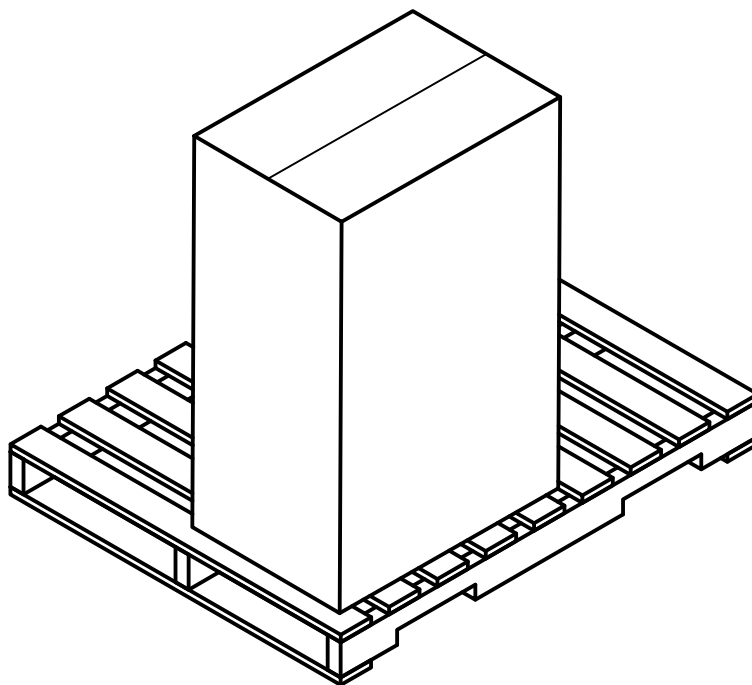



2 – SPECIFICATIONS AND OPTIONS

PULLDOWN SPECS

- For ease of pulldown use, make sure the unit does not surpass 35lbs of weight or 11lbs per shelf.
- Total unit weight 88 lbs
- 83° Restrictor clip stop adjustment
- No Doors option available

USAGE AND FEATURES

- Hydraulic pull-down shelving provides; easy access to materials.
- Maximizes use of vertical storage space without sacrificing safety.
- Open shelving allows for visual inventory. Know at a glance, what you have and where it is.
- Tilt Bins (not included) under unit allows for quick and customizable arrangement of materials.

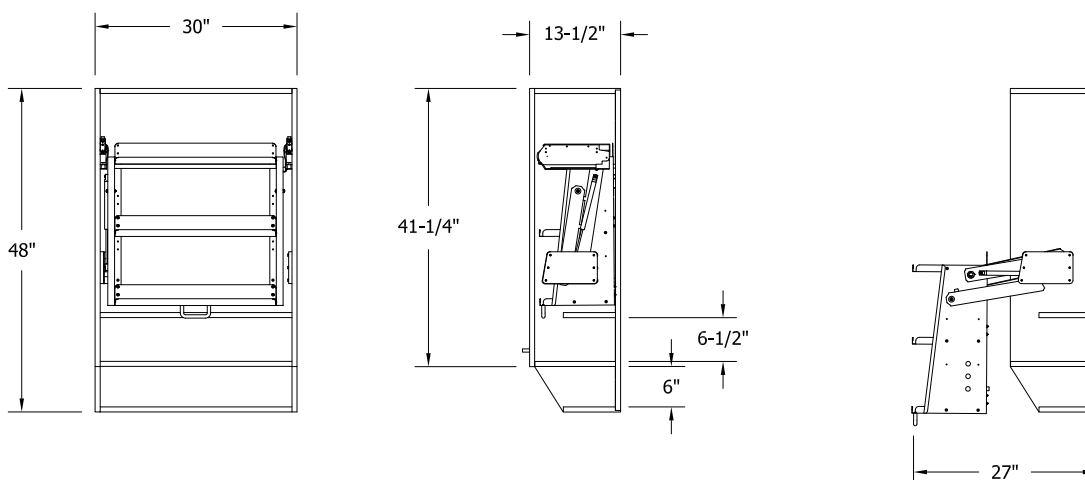

OPTIONAL FEATURES

TILT BIN - OPTIONS

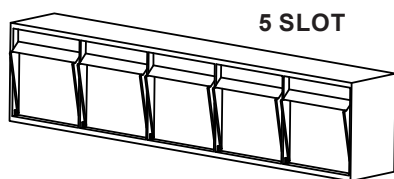

5 SLOT

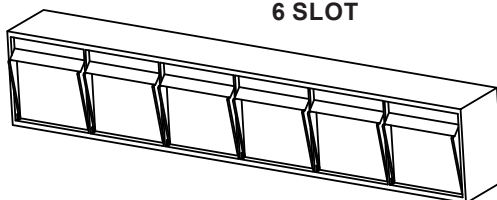

6 SLOT

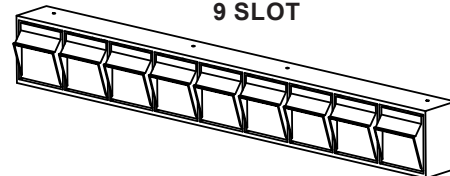

9 SLOT

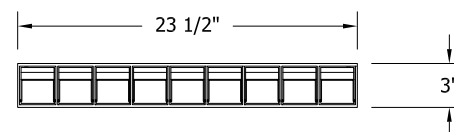
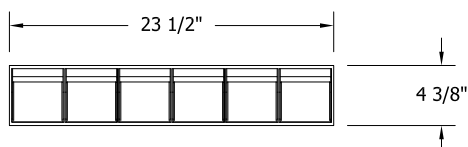
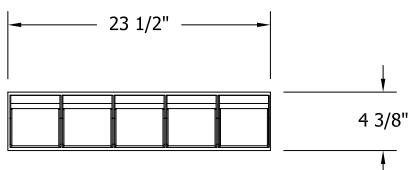



3 – FRAMING

During the framing process, a 2"x 6" or equivalent cabinet blocking should be installed at 54" above the finished floor and again at 102" above the finished floor. This will provide necessary support for your Pulldown.

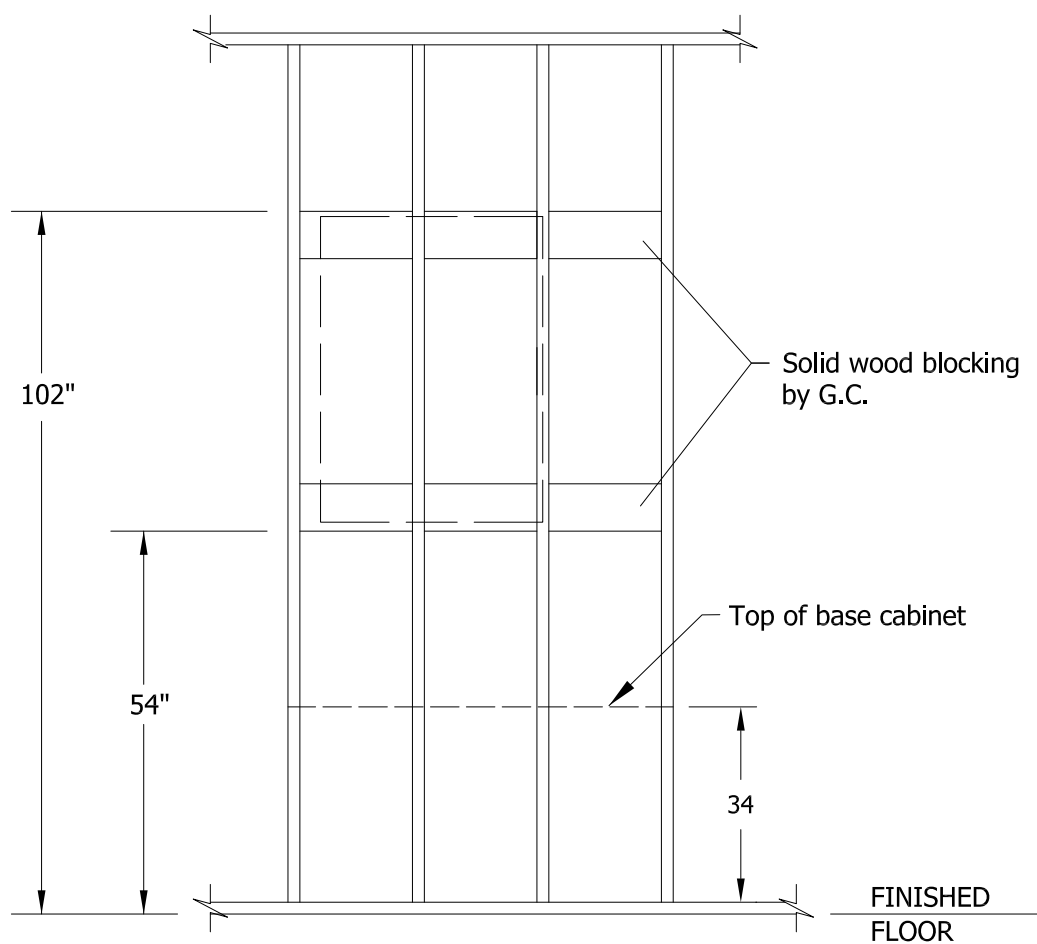



4 – INSTALLATION

1. Position the bottom of the cabinet 54" above the finished floor, or align tops with adjacent cabinets where indicated on the elevation. This height is required for proper use of the pulldown fixture.
2. Make sure unit is level.
3. Using six #8x2-1/2" screws, secure the cabinet into the cabinet blocking through the cleats of the cabinet as shown in Fig. 3.1. Use three screws along the top, and then three along the bottom.

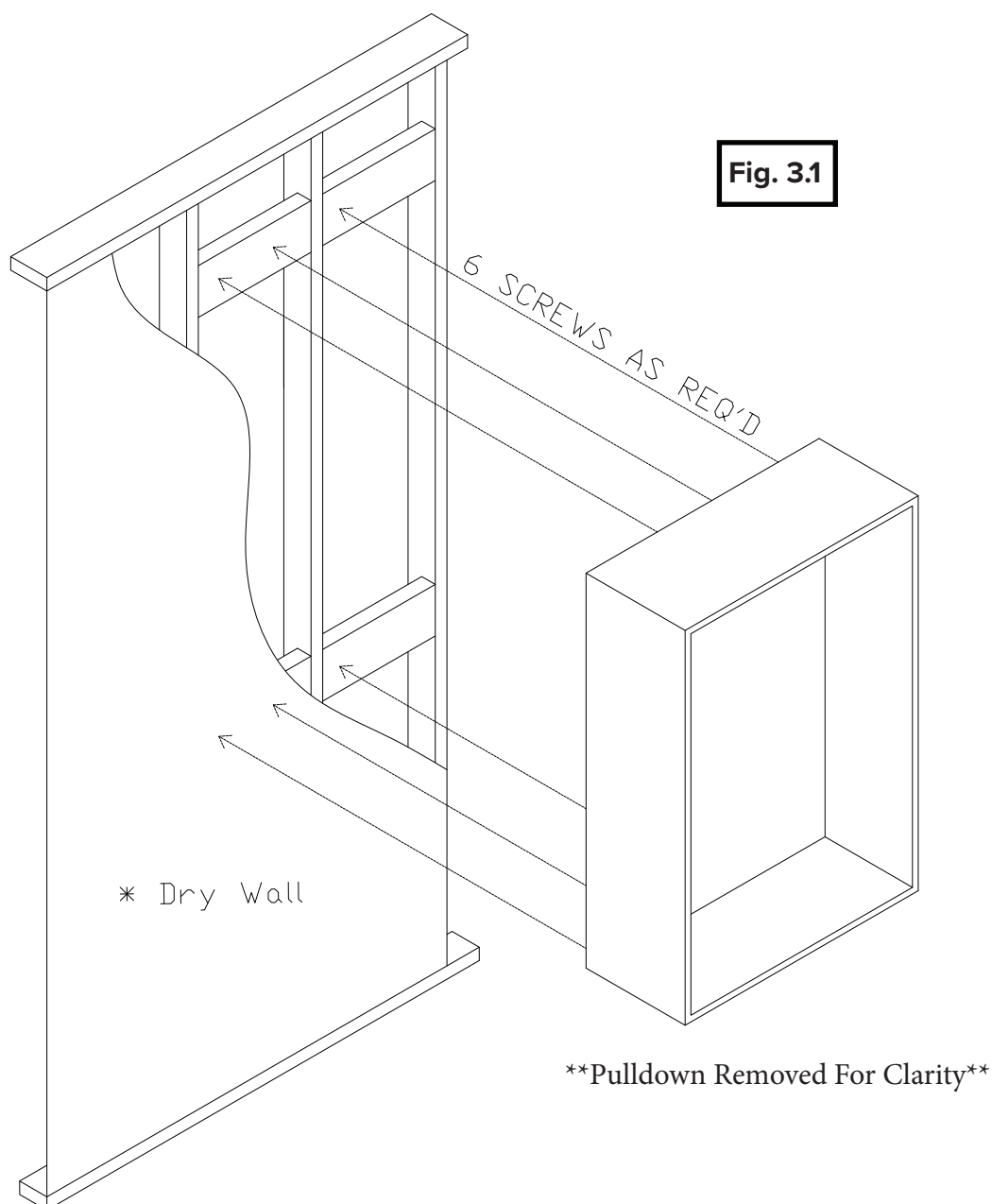



4 – INSTALLATION cont'd

INSTALLATION WITHOUT CABINET BLOCKING:

Although it is our recommendation to install the Triple Pulldown using the cabinet blockings, it is possible to install without them.

1. Position the bottom of the cabinet 54" above the finished floor centering the cabinet horizontally over two (2) studs. This will allow for proper spacing.
2. Make sure the unit is level.
3. Secure the cabinet using six (6) #8x 2-½" screws into the studs with three (3) screws spaced evenly down the left side and three (3) screws spaced evenly down the right side.

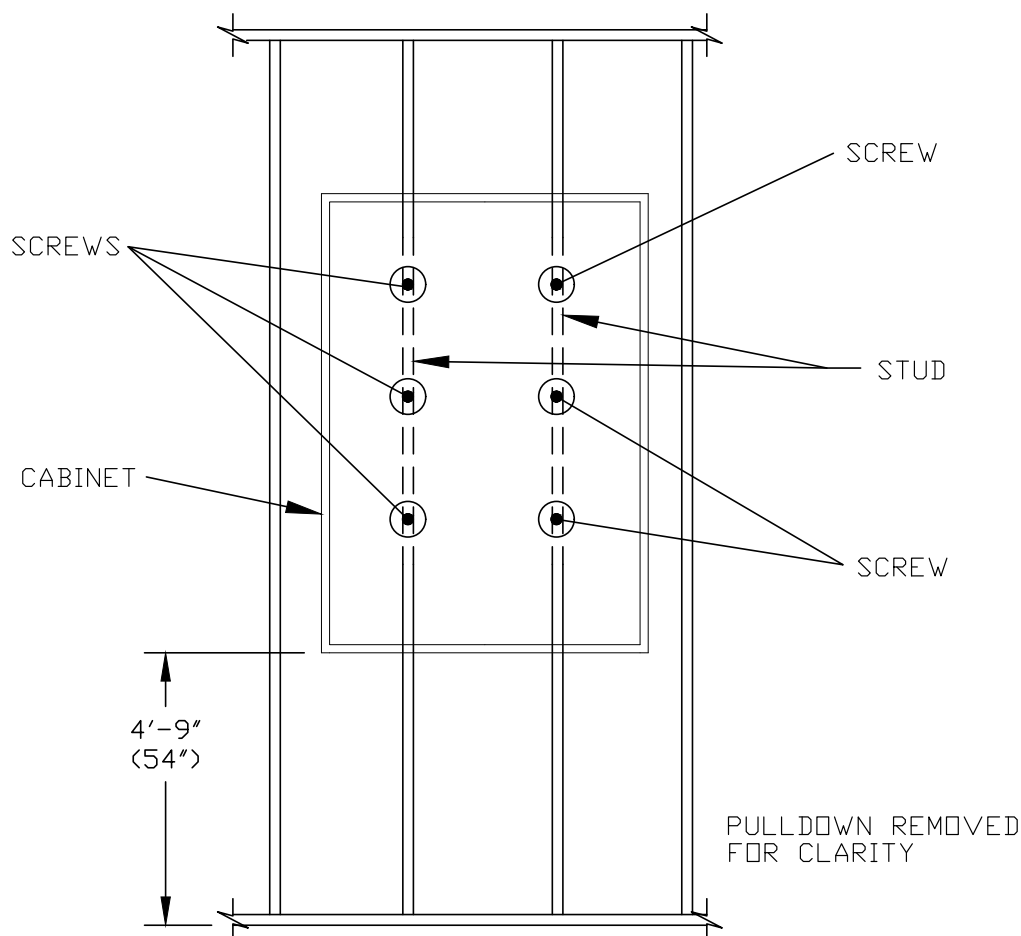



5 – INSTALLATION FOR TILT BIN *OPTIONAL*

1. Remove tilt bin from packaging
2. Using supplied screws (four (4) #6 x 5/8" philips-head screw), attach tilt bin frame to the back of the wall and up against the bottom of the cabinet.
3. Installation complete.

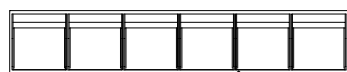
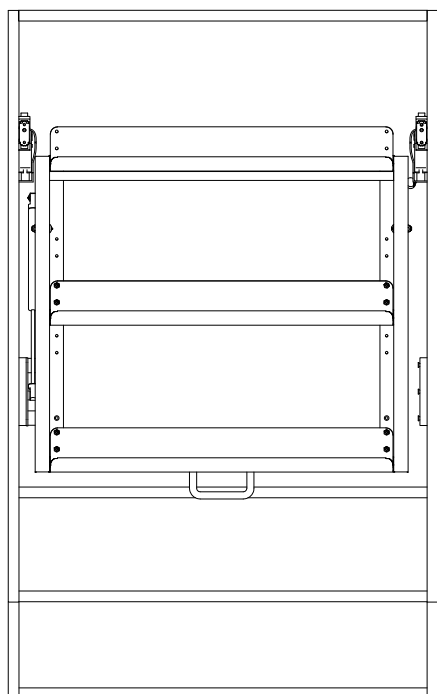

Tilt Bin

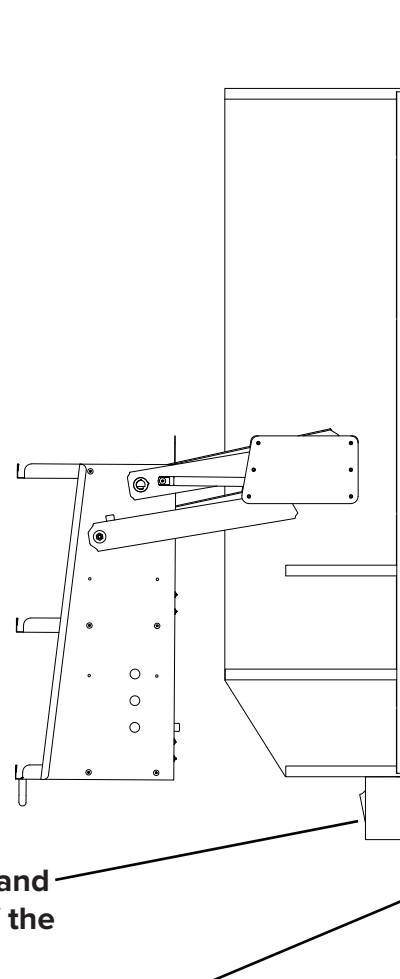

Tilt Bin is mounted to wall and
is up against the bottom of the
cabinet

Mounting Wall