



ergonomic products

Performance Without Compromise™

Installation and Operations Manual

C3A Series: SlimLine Universal Headwall

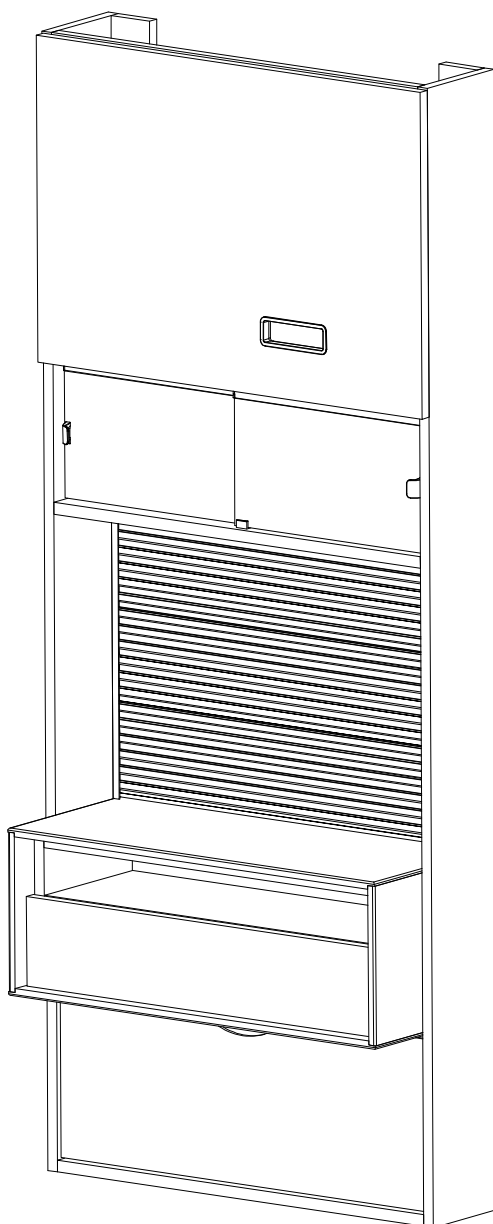

Product ID: **C3A1**
Manual version: **A**



Thank you for purchasing the Ergonomic Products C3A Series SlimLine Universal Headwall.

Years of research by dentists, engineers, and designers have made this a uniquely effective product in the industry. We stand behind our equipment, and genuinely believe it to be the best available on the market.

Should you have any questions regarding the product's installation or use, please don't hesitate to call our Customer Service Specialists at **1-866-ERGO-4-US**. We may also be reached via email at **equip@ergonomic-products.com**.

We hope that you enjoy the benefits and quality of your new equipment and look forward to assisting you with your future needs as your practice continues to grow!

—The Ergonomic Products Team

CONTENTS:

1. Dimension Specifications.....	3
2. Headwall Anatomy.....	4
3. Options for your headwall.....	5
4. Using your Headwall.....	6
5. Unpacking and Inspecting.....	7
6. Suggested Blocking Method.....	8
7. Mounting the Counter Top.....	9
8. Mounting the Slat Wall.....	11
9. Mounting the Headwall.....	13
10. Plumbing/Wiring Schematic.....	14
11. Using the Under Cabinet Light.....	15
12. Maintenance.....	16

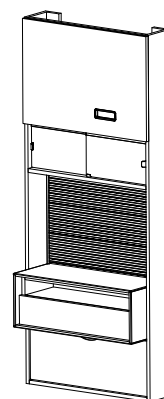

QUESTIONS?

Call our Customer Service Specialists at:
1-866-ERGO-4-US



1 - DIMENSION SPECIFICATIONS

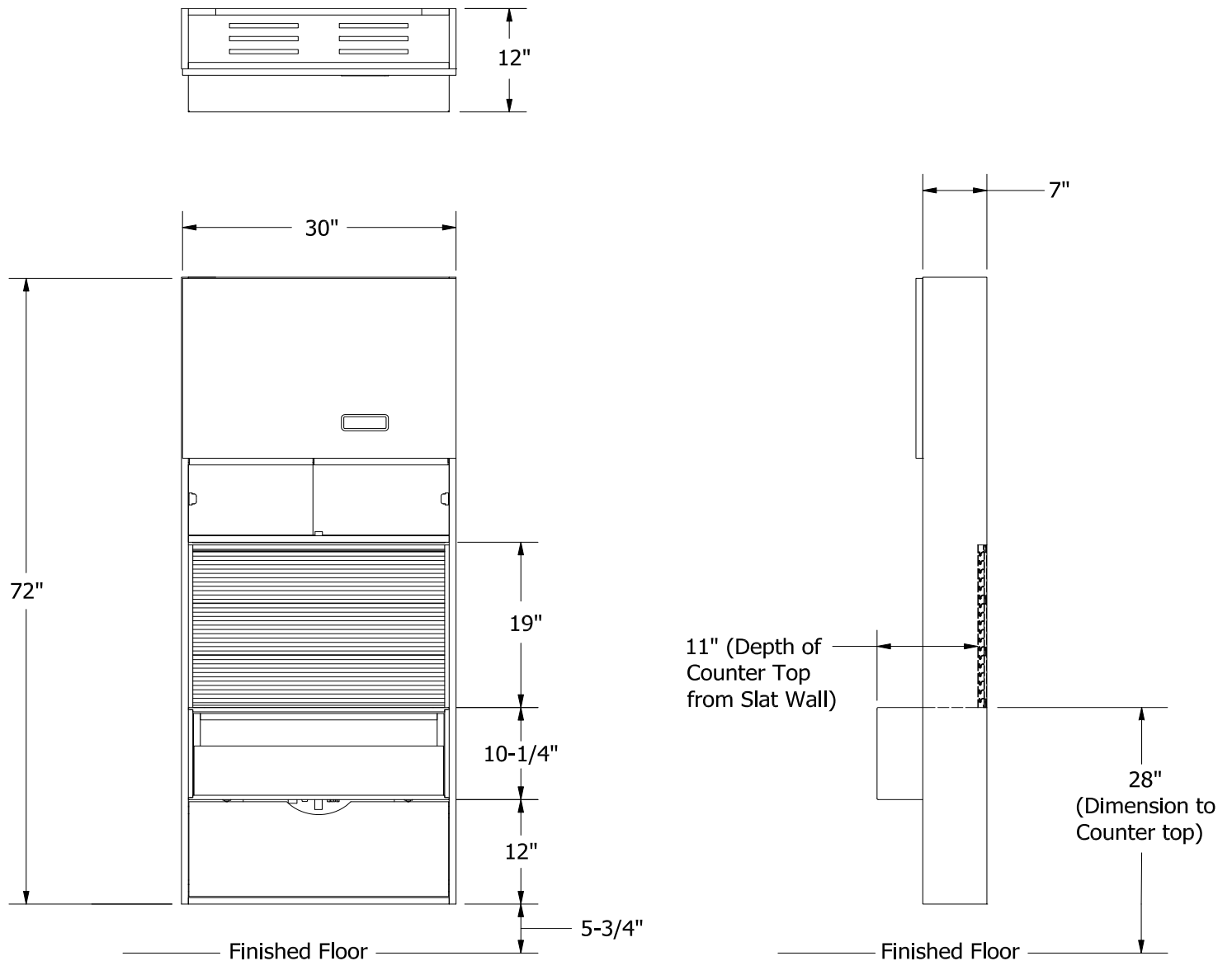

Fig 1.1 - Dimensions of the SlimLine Headwall.



2 - HEADWALL ANATOMY

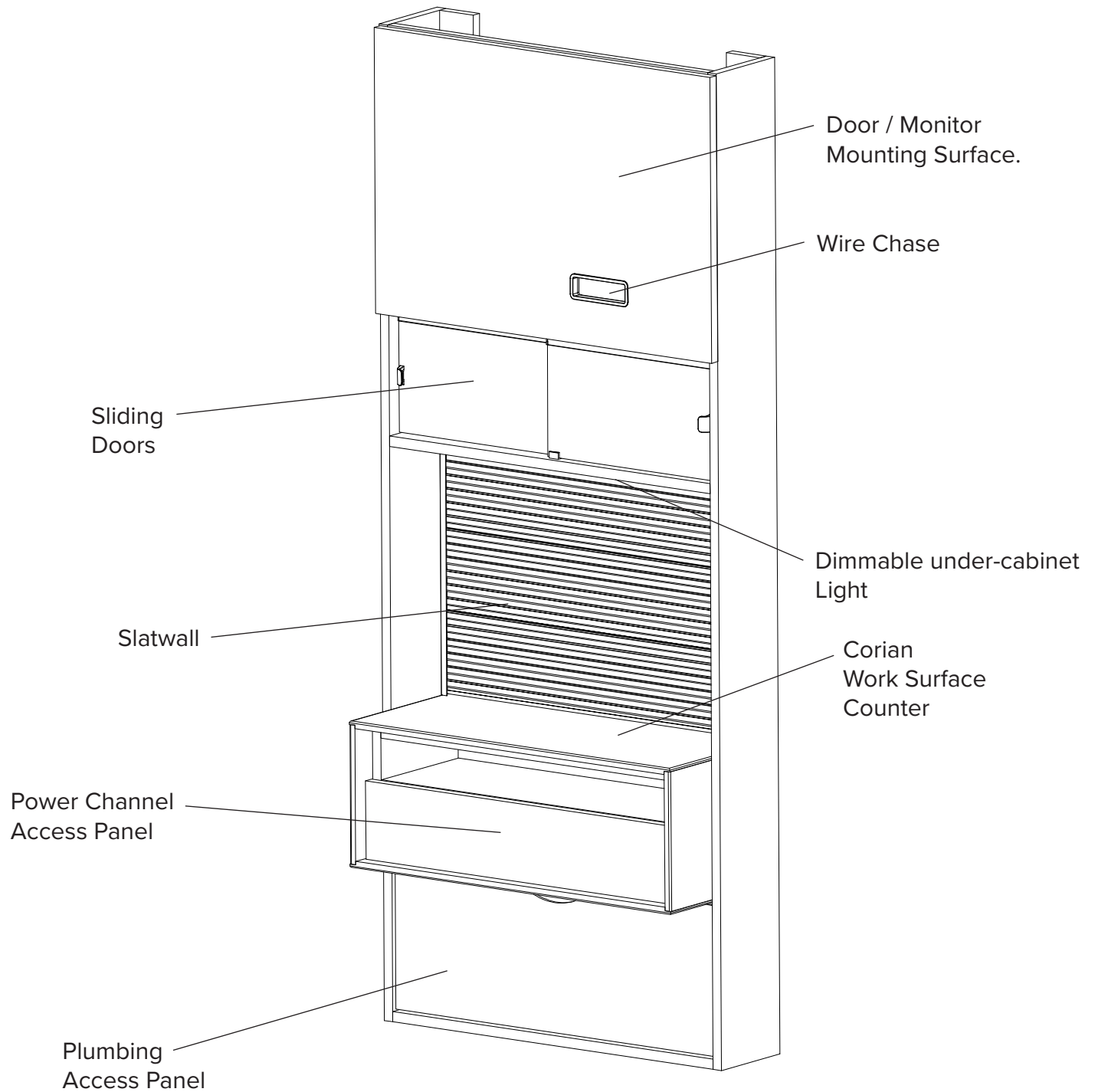

Fig 2.1 - SlimLine Universal Headwall Features



3 – OPTIONS FOR YOUR HEADWALL

NITROUS OPENING:

The Nitrous Opening can be done on site and can be on either the left or right side.

Note: Please contact your Ergonomic Products representative for more information on the “Nitrous Opening.”

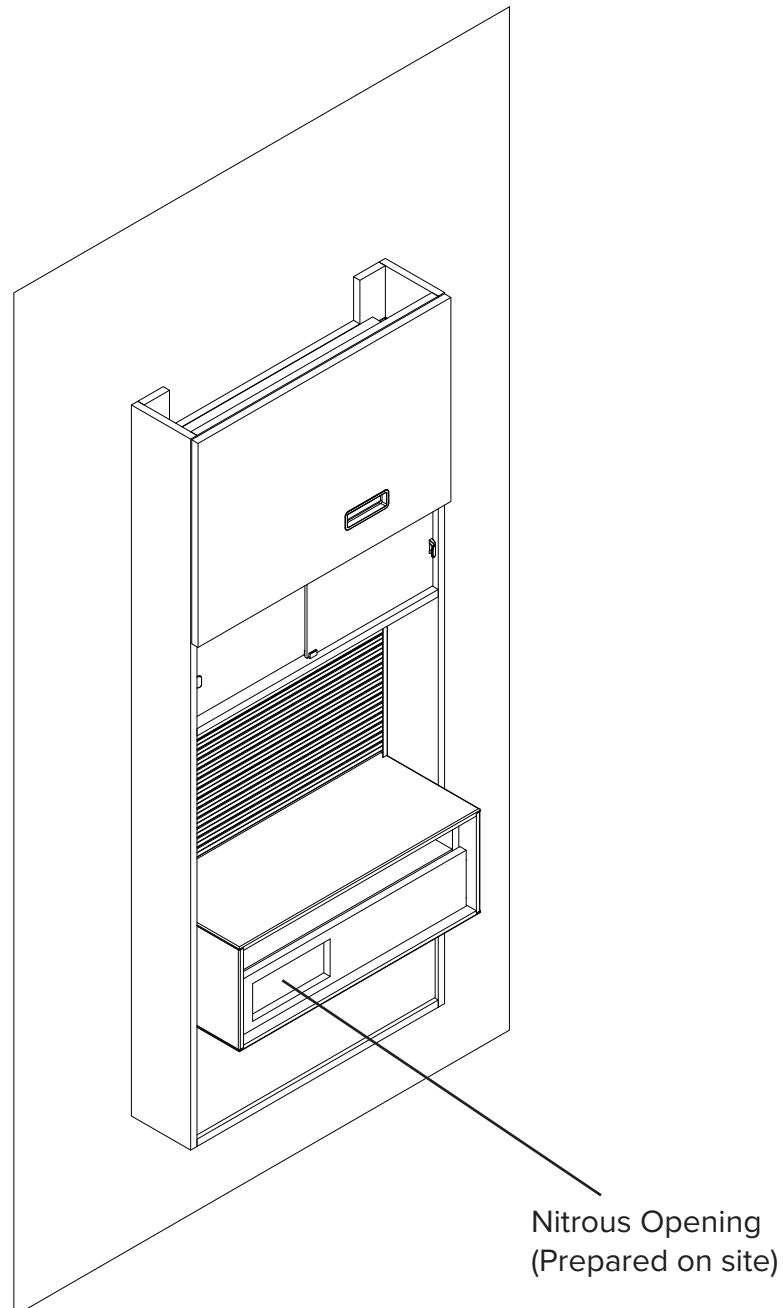



4 – USING YOUR HEADWALL

IDEAL ROOM LOCATION

The SlimLine Universal Headwall is a highly efficient utility, storage, and work center. It is most effective when used in a dual / head-entry format. In conjunction with the any of our Workstations, this creates an ideal ergonomic production zone that is out of the patient's line-of-site on entry to the operating room.

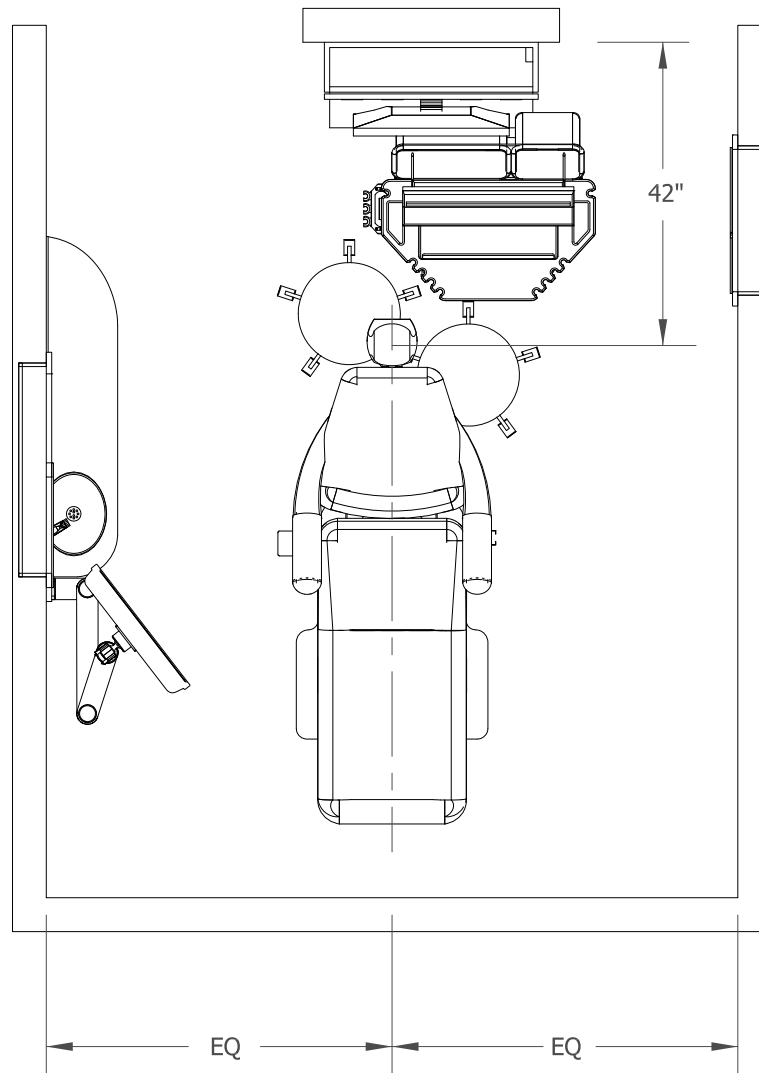



5 - UNPACKING AND INSPECTING

REQUIRED TOOLS

Utility Knife
Phillips Head Screwdriver
Electric drill and Assorted Bits

1. Inspect shipping containers (Fig 5.1) for visible damage upon arrival. If transit damage is found, contact Ergonomic Products immediately. (This will expedite the corrective process.)
2. Use safe lifting procedures to free the product from the container, and remove all packing material and accessory boxes from shipping container.
3. Lay individual components on clean surface to avoid scratching, and inspect contents. If damage is found, contact Ergonomic Products immediately.
4. Do not discard accessory boxes without thoroughly checking that all products and parts have been removed.

Corian Box
(90 lbs weight)

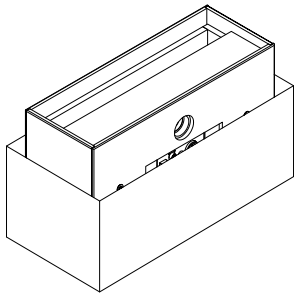

HeadWall Box
(100 lbs weight)

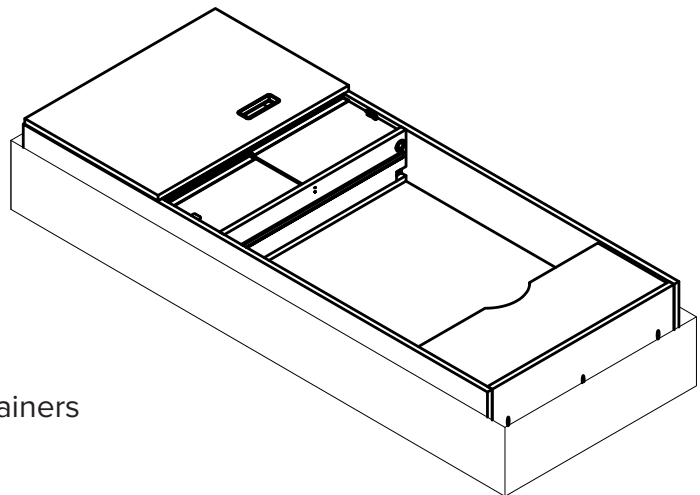

Fig 5.1 - Shipping Containers



6 - SUGGESTED BLOCKING METHOD

Please note all dimensions (Fig 6.1) must be maintained for optimum installation of the SlimLine Universal Headwall. Blocking to be done by licensed contractor.

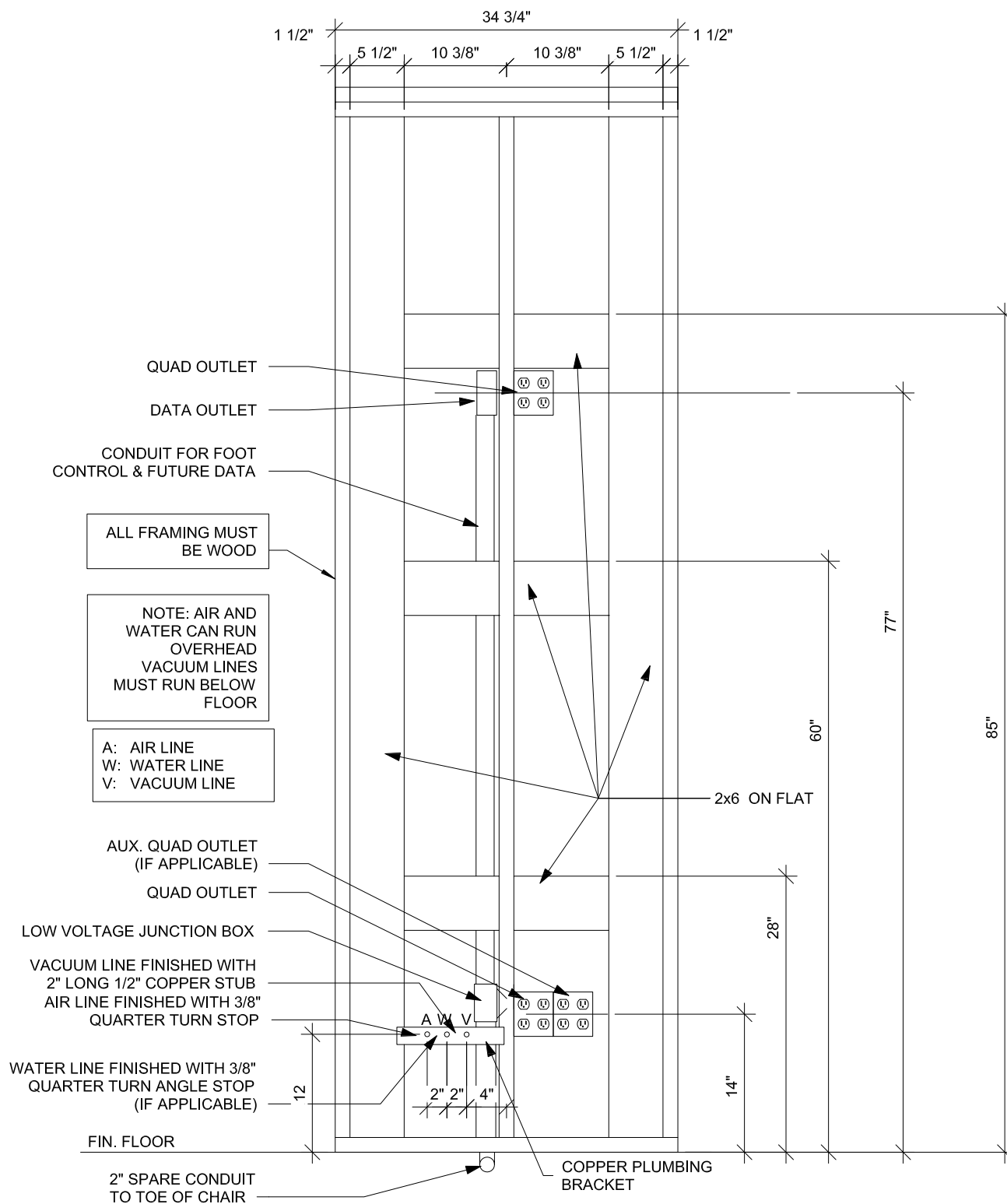
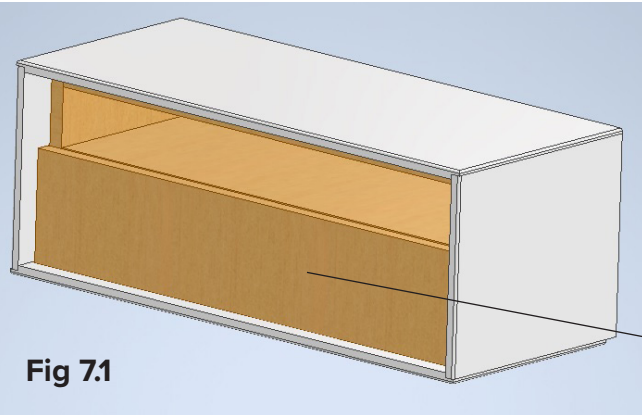

Fig 6.1 - Blocking Diagram



7 - MOUNTING THE COUNTER TOP



1. The Corian counter top is mounted on the wall and centered to the blocking (see Fig 7.1) and is 28" off the finished floor (see Fig 1.1 page 3)

Note: Be sure to level the counter top before screwing it to the wall!

Power Channel
Access Panel

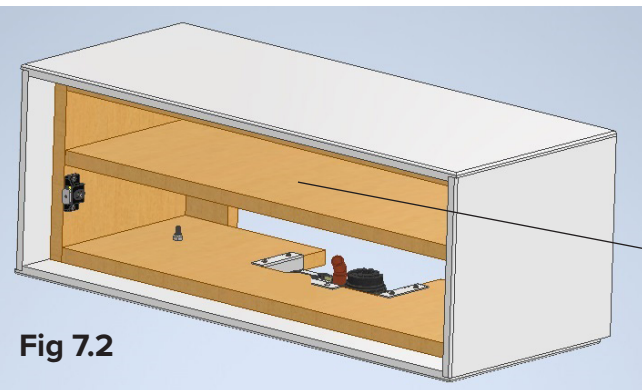

2. Remove the Power Channel Access Panel to reveal the Removable Shelf and the Quick Disconnect. The Access Panel is held in place with two magnets on each end. Pull the Access Panel towards you and the Panel comes off the magnets.

Removable Shelf

Hose Clamp
provided by
Ergonomic Products

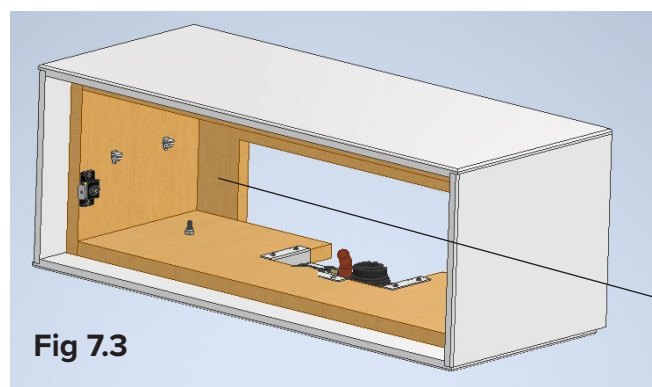
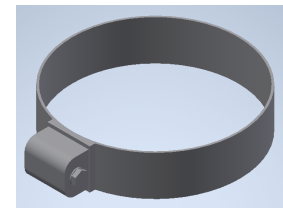

3. Remove the Shelf to reveal the back panel.

Back Panel



7 - MOUNTING THE COUNTER TOP cont'd

Follow the steps below to mount the counter top properly.

1. Mark out the drywall with a line that's 28 inches from the floor (see Fig 7.2). This line will represent the top of the Corian worksurface.
2. Mark out the “center stud” (see fig 5.1 page 7) on the drywall.
3. Place the Cabinet against the wall markings, and secure it with three screws as shown (Fig 7.2).
4. Once the counter is secured, replace the Adjustable Shelf and Power Channel Access Panel.

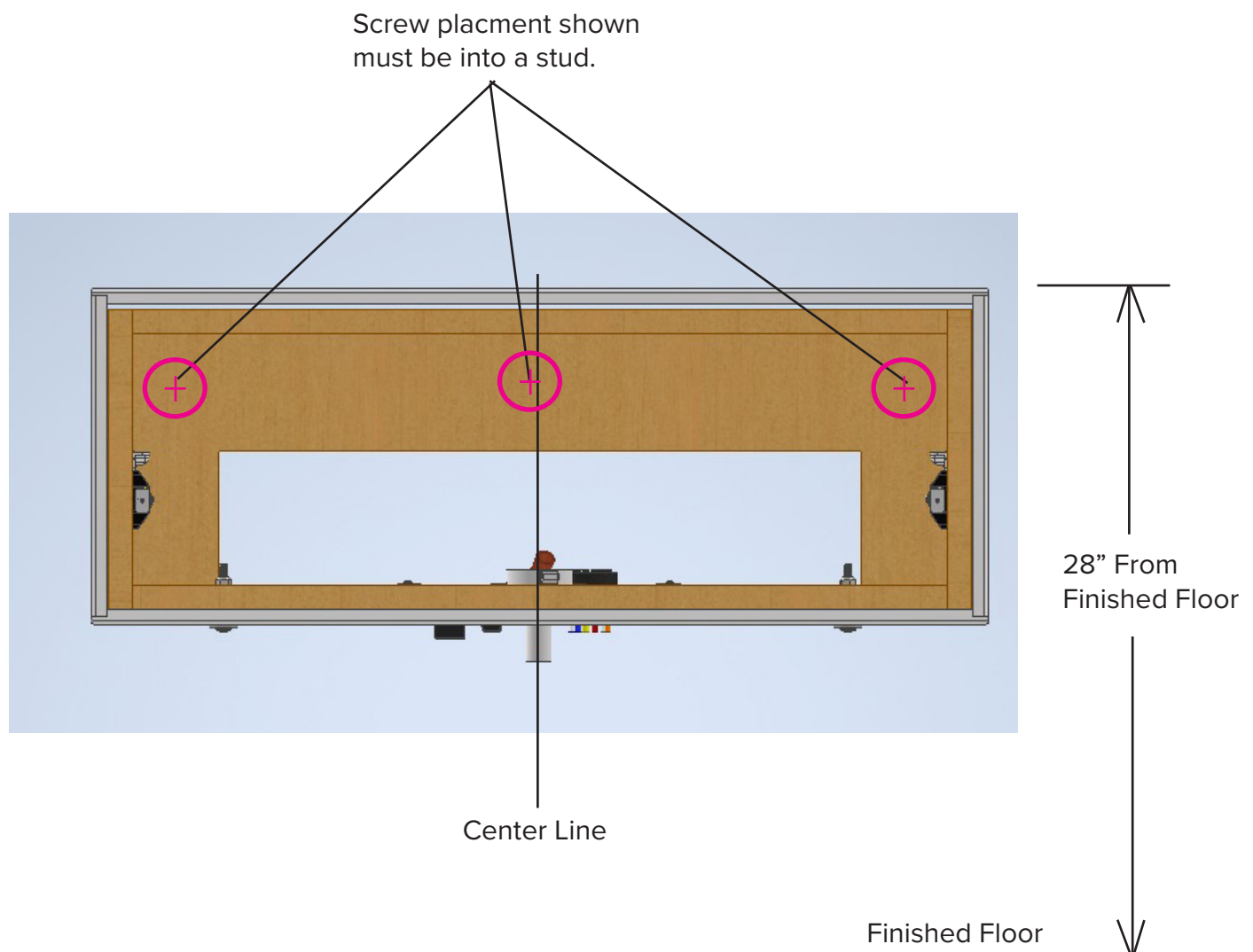

Fig 7.2 - Cabinet Mounting guide



8 - MOUNTING THE SLAT WALL

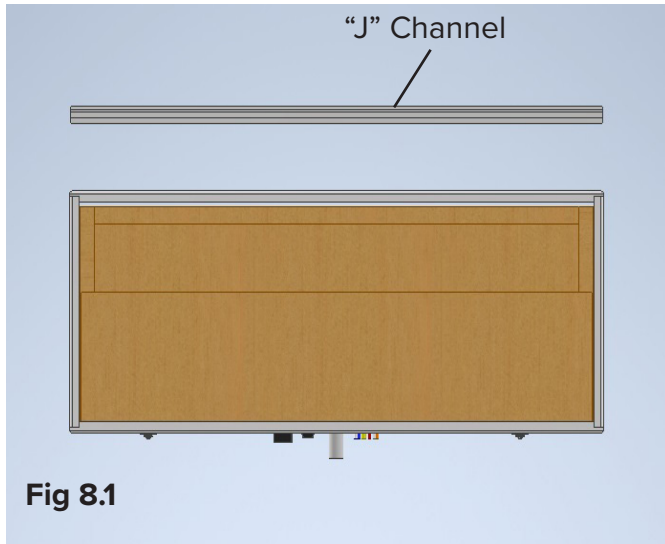

Fig 8.1



Note: Please use #6 1-1/2" long sheet metal screws when securing the Slat Wall

1. The Slat Wall stack starts with the "J" Channel and is set on top of the Corian counter, be sure to center the "J" channel on the counter (Fig 8.1).

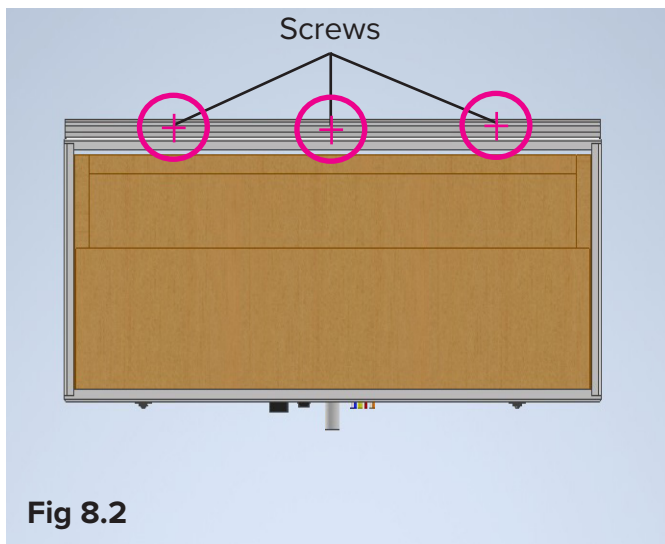

Fig 8.2

2. Secure the "J" Channel with three screws into each stud (Fig 8.2).

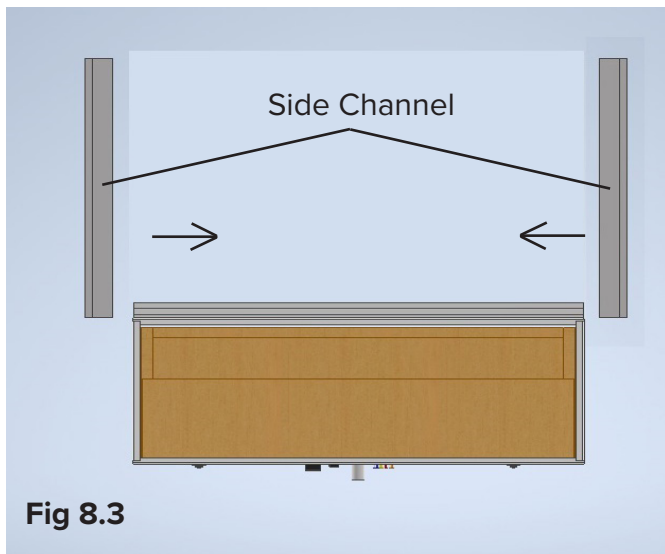

Fig 8.3

3. Slide the Left and Right side Channel uprights behind the "J" Channel (Fig 8.3).

Note - Be sure to level the Side Channels while installing the Slat Wall sections.



8 - MOUNTING THE SLATWALL cont'd

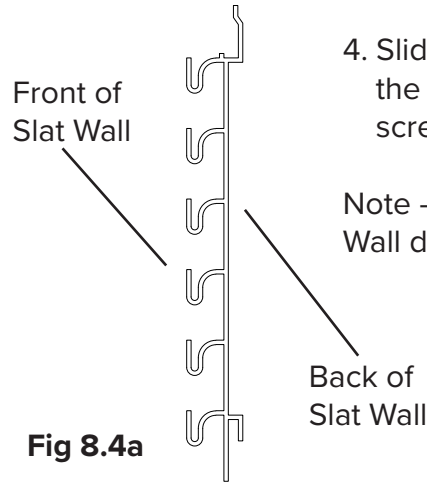
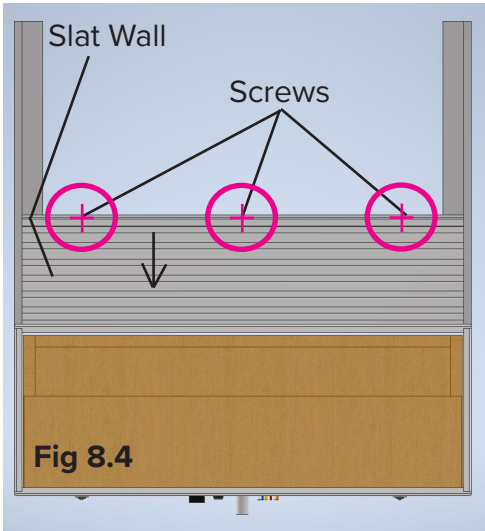

4. Slide the first Slat Wall section in between the uprights and secure in place with three screws (Fig 8.4).

Note - See Fig 8.4a on orientation of the Slat Wall during installation.

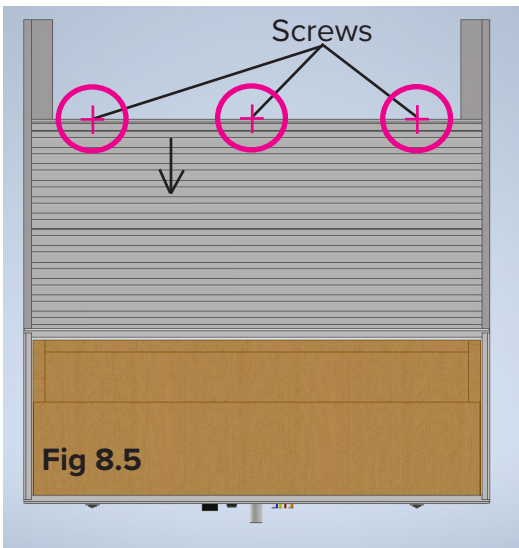

5. Slide the next Slat Wall section in between the uprights and secure in place with three screws (Fig 8.5).

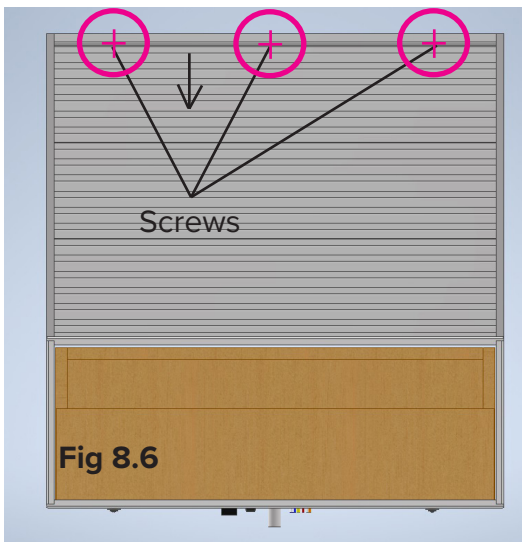

6. Slide the final Slat Wall section in between the uprights and secure in place with three screws as shown in (Fig 8.6).

Place the Slat Wall cap on top of the finished Slat Wall stack.



Ergonomic Products offers many slat wall accessories to optimize the function of your headwall. Please scan the QR code for available options



9 - MOUNTING THE HEADWALL

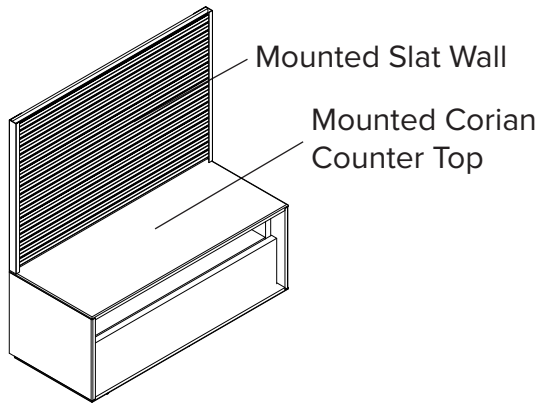

Fig 9.1

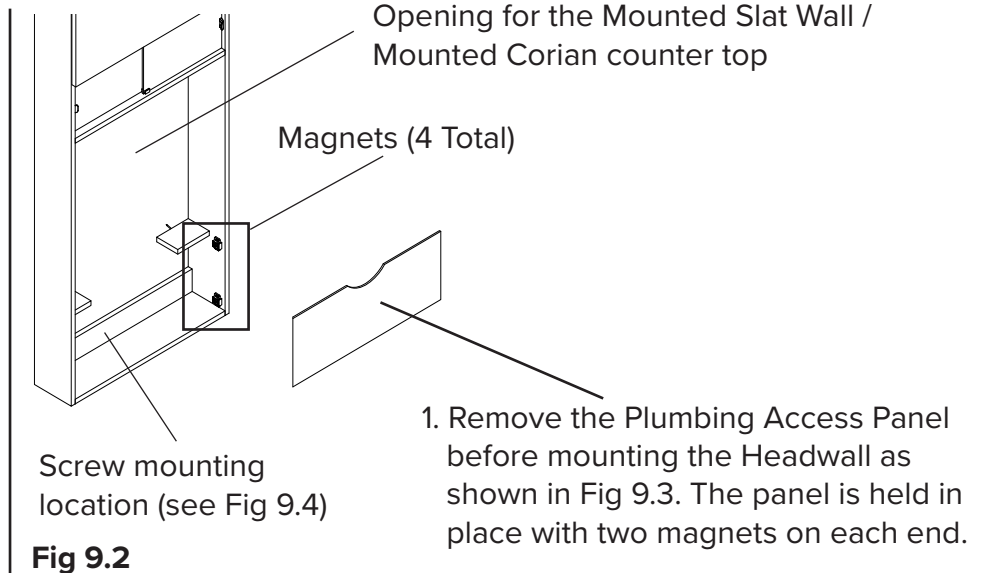

Fig 9.2

2. Mount the Headwall over the Slat Wall / Corian Counter Top through the opening of the Headwall, (Fig 9.3) and secure the Headwall using the screw mounting locations as shown in Fig 9.4, and Fig 9.5.

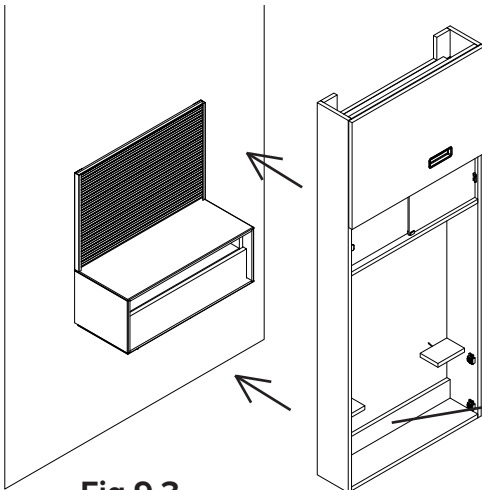

Fig 9.3

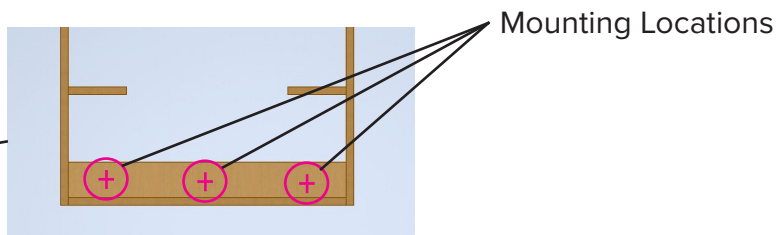

Fig 9.4

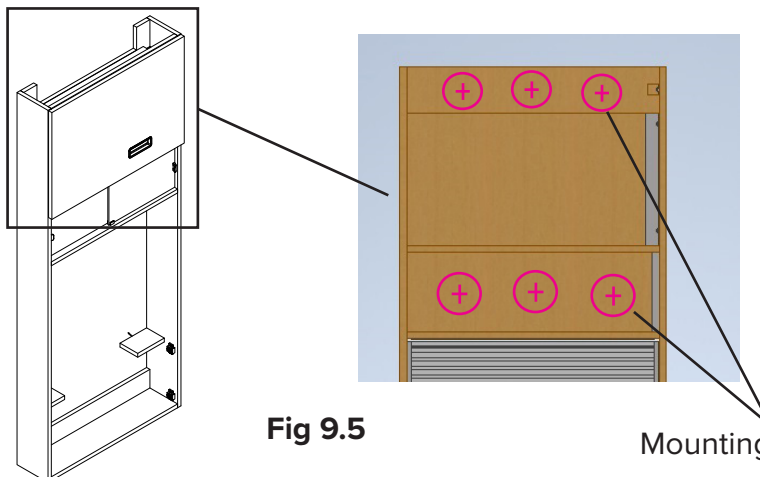

Fig 9.5

4. Secure the upper part of the Headwall into the blocking as shown in the approximate locations and into in Fig 9.5.

Note: Doors are removed from the image for clarity.



10 - PLUMBING / WIRING SCHEMATIC

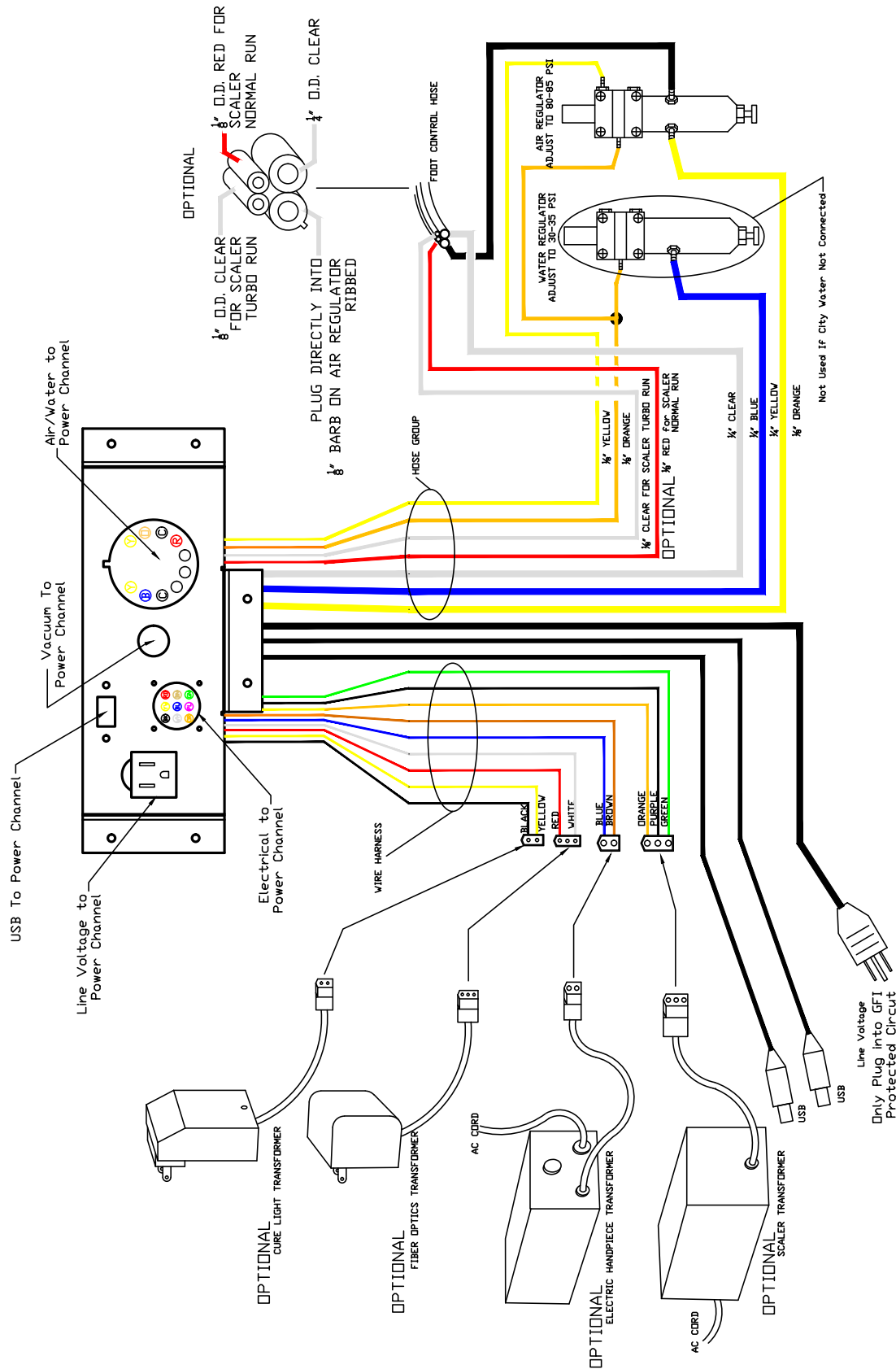

Fig 10.0 - Plumbing / Wiring Schematic



11 - USING THE UNDER-CABINET LIGHT

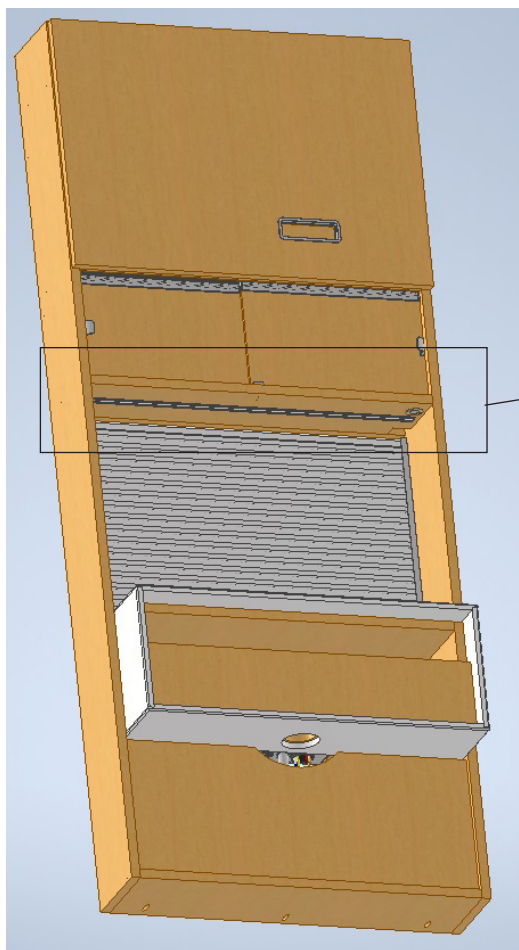



Fig 11.0

VOLTAGE AND WATTAGE SPECS

V_{IN} 	 V_{OUT}	T_A	W
100 - 240 V 50 / 60 Hz	12 V	-25 °C – +45 °C -13 °F – +113 °F	20 W

Light Bar

The SlimLine Universal Headwall includes a dimmable LED Light Bar.

To turn the Light Bar on, place your hand on the Sensor and hold until light turns on.

To dim the light, hold your hand on the Sensor until desired light level is achieved

To turn off the light, place your hand on the sensor until light is off

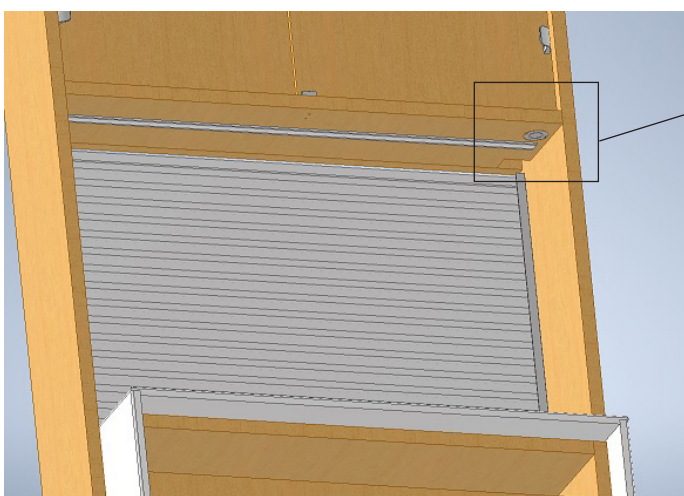

Touch Sensor

Fig 11.1



12 – MAINTENANCE

CLEANING AND DISINFECTING DENTAL UNITS AND ENVIRONMENTAL SURFACES:

GENERAL GUIDELINES:

After treatment of each patient and at the completion of daily work activities, countertops and dental unit surfaces that might have been contaminated with patient material or when the surface is contaminated with biological material must be cleaned with disposable toweling (for example PDI Super Sani Cloth) and water as necessary. Then disinfect surfaces with a suitable chemical germicide (for example DisCide Ultra Disinfectant Spray).

The CDC recommends using a chemical germicide registered with the EPA as a “hospital disinfectant” and labeled for “tuberculocidal” (i.e., mycobactericidal) activity to disinfect surfaces that have been soiled with patient material. These intermediate-level disinfectants include phenolics, iodophors, and chlorine-containing compounds. Because mycobacteria are among the most resistant groups of microorganisms, germicides effective against mycobacteria should be effective against many other bacterial and viral pathogens.

Low-level disinfectants—EPA-registered “hospital disinfectants” that are not labeled for “tuberculocidal” activity (e.g., quaternary ammonium compounds)—are appropriate for general housekeeping purposes such as cleaning floors, walls, and other housekeeping surfaces. The CDC does not recommend using intermediate- and low-level disinfectants to reprocess critical or semi critical dental instruments.

CDC Guideline for Disinfection and Sterilization in Healthcare Facilities, 2008; Centers for Disease Control and Prevention. Guidelines for Infection Control in Dental Health-Care Settings— 2003. MMWR 2003;52(No. RR-17):[inclusive page numbers]. FDA Processing/Reprocessing Medical Devices in Health Care Settings: Validation Methods and Labeling DRAFT GUIDANCE May 2, 2011.



12 – MAINTENANCE cont'd

CLEANING:

METAL COMPONENTS:

Use mild detergent and water or any of the commercially available sprays, such as 409, Fantastic, or others, with a soft cloth or sponge. **DO NOT USE ABRASIVES** as these will permanently scratch the finish.

PLASTIC, RUBBER, AND PAINTED SURFACES:

Use mild detergent and water or any of the commercially available sprays, such as 409, Fantastic, or others, with a soft cloth or sponge. **DO NOT USE ABRASIVES** as these will permanently scratch the finish.

CORIAN® SURFACES:

Your Corian surfaces are delivered with a matte/satin finish and any of the above cleaners are acceptable. Minor surface blemishes can be brought back to a like-new finish with the use of a mild abrasive cleaner such as Comet on their own or in conjunction with a green or white Scotch-Brite Pad.

Clean with warm, soapy water or any non-abrasive ammonia based cleaner or disinfectant. Dry thoroughly after cleaning. For tougher stains, use Clean EnCounters® from DuPont. **Do NOT** use window-cleaning solutions (they will leave a waxy build-up), ScotchBrite or other abrasive pads.

For more information on cleaning CORIAN surfaces, go to:

<http://www.dupont.com/products-and-services/construction-materials/surface-design-materials/brands/corion-solid-surfaces/articles/how-to-clean-corian.html>

Dried composites can be scraped off using a single-edged razor blade or equivalent, being cautious not to dig into the surface.

If the surface becomes too scarred to be renewed with the above procedures, a resurfacing can be done. Please contact us or any Corian-certified installer for the correct procedure.

*The FDA recommends that items contaminated with blood or body fluids, which might contain blood-borne pathogens, must receive intermediate level disinfection with a product having an EPA-registered claim for activity against hepatitis B after cleaning.