

Essential Work Center™ (Item C2E1)



Expand your **efficiency**
and productivity levels...
not your budget.

Standard Features

- 3-1/2 sq ft of solid Corian Work Surface
- Over 6 sq ft of Slat Wall face can receive a wide array of accessories
- Corian Top-cap & Backsplash
- Quality aluminum side rails (white powder coating) can be custom configured to support a variety of media/device requirements (electrical/data plates not included)
- Removable Utility Access Panel
- Suited for use with a variety of Workstation delivery units

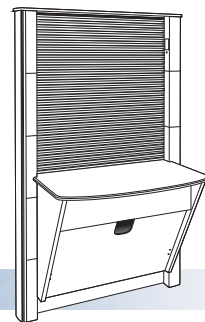

CONFIGURATION, UPGRADE and COLOR CHOICES

Cabinet Color/Finish Selection:

- Cabinet available in standard EP color choices.
- or - Upgrade to woodgrain finish. (Standard EP selections)

Corian Work Surface:

- Available in standard and premium EP Corian color choices.

Utility Configuration

- Standard Utility Connection opening, shown above
- or - Quick Connect
(If used with EP Quick Connect Workstations.)
- or - No utility opening (solid utility access panel face)

The Universal Headwall above is shown with a range of Slat-Wall accessories. Ergonomic Products offers the items below, and others are available from a variety of resellers.

- Med-waste Bracket
- Remote Control Holder
- Sanitation Wipes Holder
- Pad & Pen Holder
- "Goodie Bag" Brackets
- Printer Shelf
- Monitor Bracket
- Single or Triple Glove Box Holders

See page 92 for details.





Dimensions & Utilities

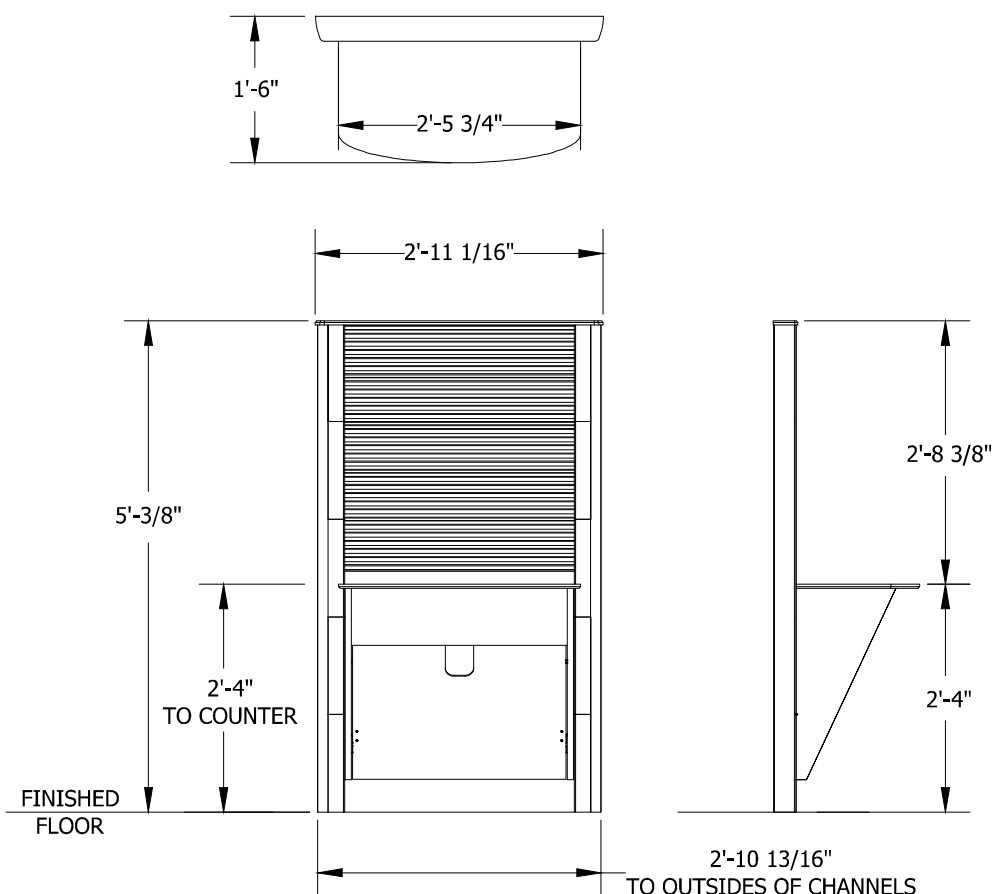

Electrical Specifications

120v AC, 60HZ, 8A
Cat 5 (or better) Data Jack

Air / Vacuum Specifications

Air: 1/4" Dental Style Female QD, 80 psi
Vacuum: 1/2" Copper or PVC Pipe

Plumbing Specifications

Dental Line feed:
- 1/2" Cold or Dedicated Dental supply line with straight 1/4 turn-stop and 3/8" compression

Ideal Room Location

EP's Essential Work Center is designed to be used with a range of umbilical-connection Workstations, including the EP Horizon, the EP Terra and others.

It may be positioned as a Headwall for dual-entry operatories (shown right), or as a low-profile solution for toe-entry and dedicated hygiene rooms.

